

6 發展項目的所在位置圖 LOCATION PLAN OF THE DEVELOPMENT

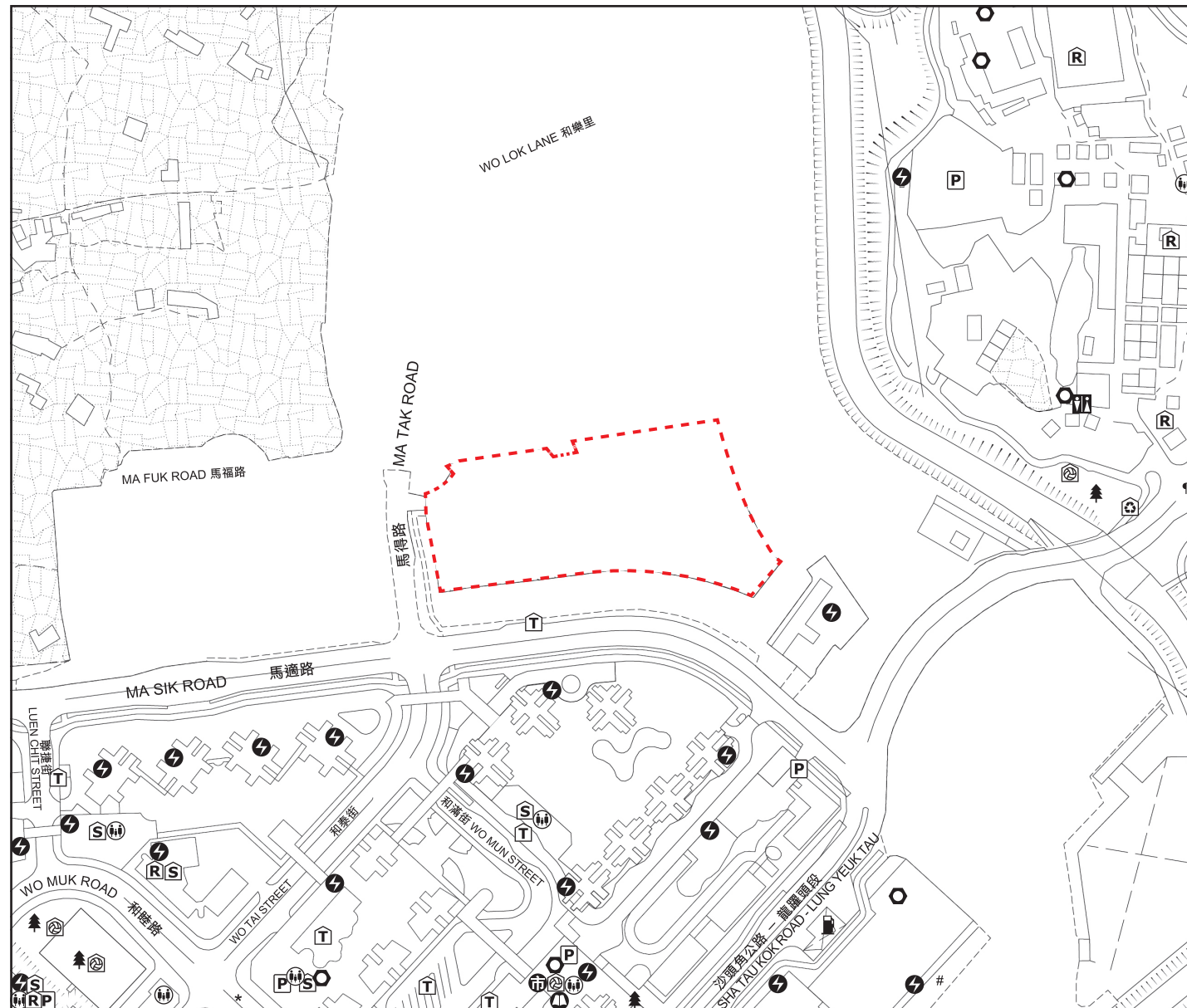

發展項目的位置
Location of the Development

比例尺 SCALE
米 metres 0 50 100 150 200 250

於發展項目的所在位置圖未能顯示之街道全名：

Street name(s) not shown in full in the Location Plan of the Development:

* 聯安街 LUEN ON STREET # 安樂門街 ON LOK MUN STREET 沙頭角公路 - 龍躍頭段 SHA TAU KOK ROAD - LUNG YEUK TAU



此位置圖是參考2025年4月26日出版之地政總署測繪處之測繪圖，圖幅編號T3-SW-A，並由賣方擬備。

This Location Plan is prepared by the Vendor with reference to the Survey Sheet No.T3-SW-A dated 26 April 2025 from Survey and Mapping Office of the Lands Departments.

地圖由香港地理數據站提供，香港特別行政區政府為知識產權擁有人。

The map is provided by the Hong Kong GeoData Store and intellectual property rights are owned by the Government of the HKSAR.

圖例 NOTATION

公共交通總站 (包括鐵路車站) Public Transport Terminal (including Rail Station)	學校 (包括幼稚園) School (including Kindergarten)
公園 Public Park	宗教場所 (包括教堂、廟宇及祠堂) Religious institution (including Church, Temple and Tsz Tong)
油站 Petrol Filling Station	體育設施 (包括運動場及游泳池) Sports Facilities (including Sports Ground and Swimming Pool)
發電廠 (包括電力分站) Power Plant (including Electricity Sub-stations)	市場 (包括濕貨市場及批發市場) Market (including Wet Market and Wholesale Market)
公眾停車場 (包括貨車停泊處) Public Carpark (including Lorry Park)	社會福利設施 (包括老人中心及弱智人士護理院) Social Welfare Facilities (including Elderly Centre and Home for the Mentally Disabled)
公廁 Public Convenience	圖書館 Library
公用事業設施裝置 Public Utility Installation	
垃圾收集站 Refuse Collection Point	

備註：

- 賣方建議準買家到該發展地盤作實地考察，以對該發展地盤、其周邊地區環境及附近的公共設施有較佳了解。
- 由於發展項目的邊界不規則的技術原因，此圖所顯示的範圍可能超過《一手住宅物業銷售條例》所規定的範圍。

Notes:

- The Vendor advises prospective purchasers to conduct an on-site visit for a better understanding of the Development site, its surrounding environment and the public facilities nearby.
- The plan may show more than the area required under the Residential Properties (First-hand Sales) Ordinance due to the technical reason that the boundary of the Development is irregular.