

橫截面圖 A-A

CROSS-SECTION PLAN A-A

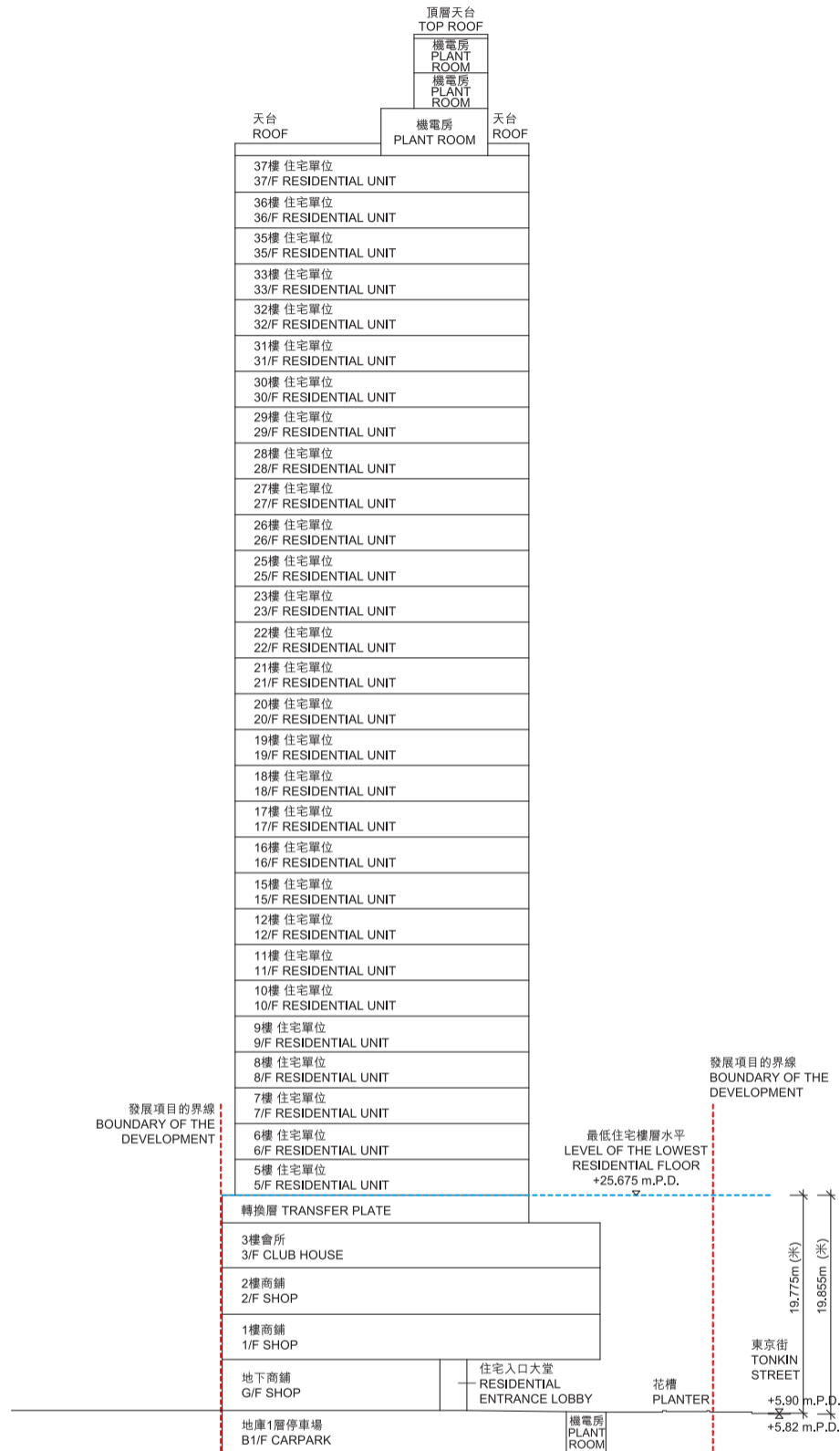

毗鄰建築物的一段東京街為香港主水平基準以上5.82米至5.90米。

The part of Tonkin Street adjacent to the building is 5.82 metres to 5.90 metres above the Hong Kong Principal Datum.

圖例 Legend

- 虛線為該建築物最低住宅層水平
Dotted line denotes the level of the lowest residential floor of the building
- ▽— 香港主水平基準以上高度(米)
Height in metres above the Hong Kong Principal Datum (m.P.D.)
- 發展項目的界線
Boundary of the Development

索引圖 Key Plan

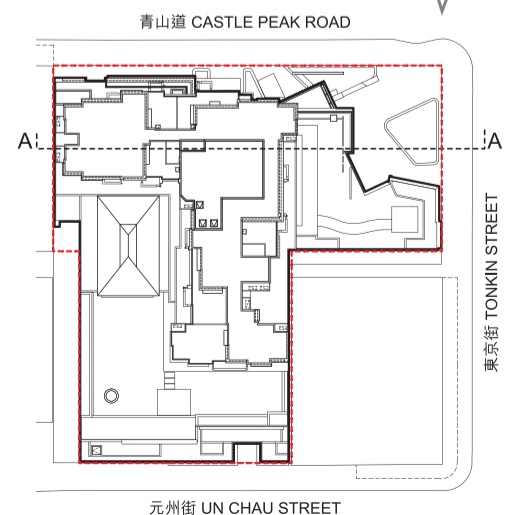

橫截面圖 B-B

CROSS-SECTION PLAN B-B

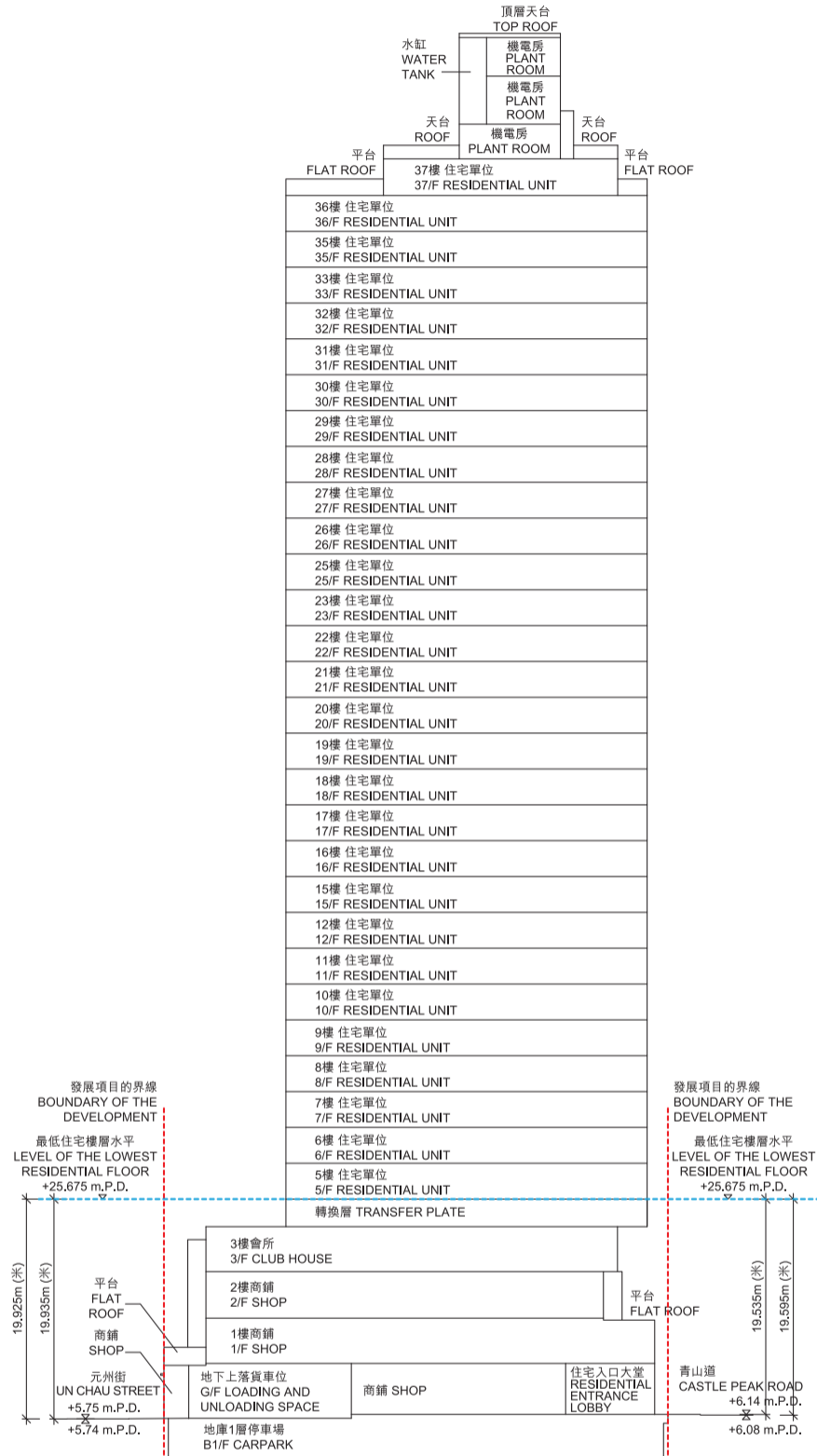

毗鄰建築物的一段青山道為香港主水平基準以上6.08米至6.14米。

The part of Castle Peak Road adjacent to the building is 6.08 metres to 6.14 metres above the Hong Kong Principal Datum.

毗鄰建築物的一段元州街為香港主水平基準以上5.74米至5.75米。

The part of Un Chau Street adjacent to the building is 5.74 metres to 5.75 metres above the Hong Kong Principal Datum.

圖例 Legend

- 虛線為該建築物最低住宅層水平
Dotted line denotes the level of the lowest residential floor of the building
- ▽— 香港主水平基準以上高度(米)
Height in metres above the Hong Kong Principal Datum (m.P.D.)
- - - - - 發展項目的界線
Boundary of the Development

索引圖 Key Plan

