

6. 發展項目的所在位置圖

LOCATION PLAN OF THE DEVELOPMENT

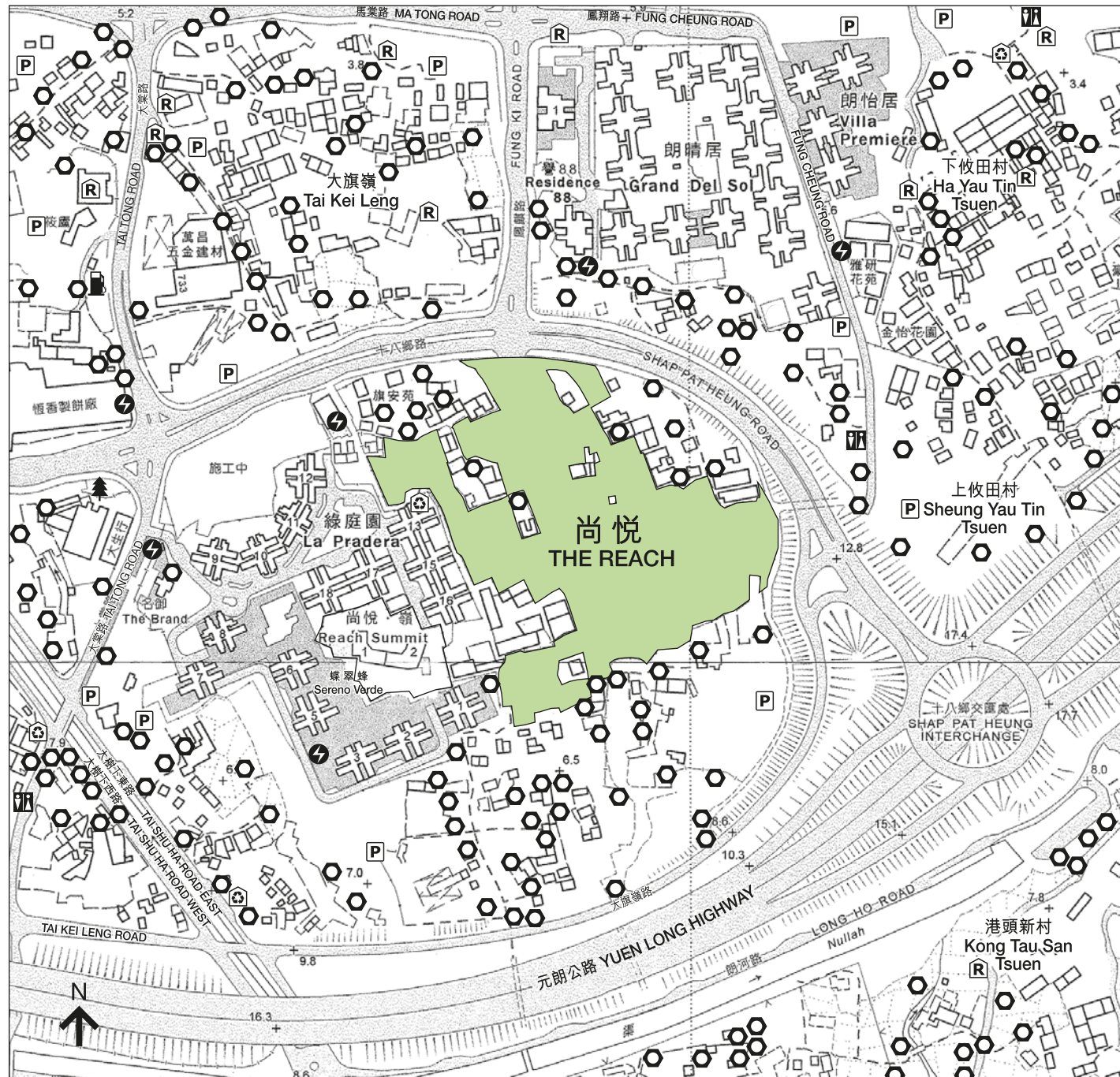

圖例 NOTATION

-  油站
Petrol filling station
-  發電廠 (包括電力分站)
Power plant (including electricity sub-stations)
-  公眾停車場 (包括貨車停泊處)
Public carpark (including lorry park)
-  公廁
Public convenience
-  公用事業設施裝置
Public utility installation
-  宗教場所 (包括教堂、廟宇及祠堂)
Religious institution (including church, temple and Tsz Tong)
-  垃圾收集站
Refuse collection point
-  公園
Public park

-  發展項目的位置
Location of the development

比例尺
SCALE 0M(米) 250M(米)

此所在位置圖摘錄自地政總署測繪處地圖組別HP5C，測量圖編號6-NW-D及6-NW-B，複印後並經修正處理。

This location plan is adopted from part of the scale maps from Survey and Mapping Office of Lands Department with Series HP5C, Survey Sheet Numbers 6-NW-D and 6-NW-B and adjustment is made where necessary.

地圖版權屬香港特區政府，經地政總署准許複印，版權特許編號53/2019。

The map reproduced with permission of the Director of Lands. © The Government of Hong Kong SAR. Licence No. 53/2019.

備註：因技術性問題，此所在位置圖所顯示的範圍超過《一手住宅物業銷售條例》的規定。

Note: Due to technical reasons, this location plan has shown more than the area required under the Residential Properties (First-hand Sales) Ordinance.