

10 FLOOR PLANS OF RESIDENTIAL PROPERTIES IN THE DEVELOPMENT

發展項目的住宅物業的樓面平面圖

The remarks and legends on this page apply to all pages of “Floor plans of residential properties in the development”.
在本頁上之備註和圖例適用於全部的「發展項目的住宅物業的樓面平面圖」所有頁數。

Legends of the Floor Plans

樓面平面圖圖例

A/C PLATFORM	= Air-conditioner Platform 冷氣機平台
A/C UNIT	= Air-conditioning Unit 冷氣機
A/C PLINTH	= Air-conditioner Plinth 冷氣機基座
BAL.	= Balcony 露台
B.	= Bathroom 浴室
B.R.	= Bedroom 睡房
DIN.	= Dining Room 飯廳
ELECT. ROOM	= Electric Meter Room 電錶房
F.H.	= Fire Hydrant 消防栓
H.R.	= Hose Reel 消防喉轆
LIV.	= Living Room 客廳
P.D.	= Pipe Duct 管道
OPEN KIT.	= Open Kitchen 開放式廚房
R.S. & M.R.R.	= Refuse Storage & Material Recovery Room 垃圾及物料回收房
TEL.	= Telephone Room 電話房
W.M.C.	= Water Meter Cabinet 水錶櫃

Remarks:

1. Common pipes exposed or enclosed in cladding may be located at the balcony, flat roof, roof or external wall of some residential units.
2. There may be sunken slabs at some parts of the ceiling inside some residential units for the installation of mechanical and electrical services of the floor above or due to the structural, architectural and/or decoration design requirements of the floor above.
3. There may be ceiling bulkheads or false ceiling inside some residential units for the installation of air-conditioning conduits and/or other mechanical and electrical services.
4. The dimensions of the floor plans are all structural dimensions in millimeter.
5. Blank areas on flat roof are common areas for building facility maintenance.

備註：

1. 部分住宅單位的露台、平台、天台或外牆或設有外露之公用喉管，或外牆裝飾板內藏有公用喉管。
2. 部分住宅單位內之部分天花或有跌級樓板，用以安裝上層之機電設備或配合上層之結構、建築設計及/或裝修設計上的需要。
3. 部分住宅單位內或設有假陣或假天花用以安裝冷氣喉管及/或其他機電設備。
4. 平面圖所列之數字為以毫米標示之建築結構尺寸。
5. 平台空白位置為供維修大廈設備使用的公用地方。

10 FLOOR PLANS OF RESIDENTIAL PROPERTIES IN THE DEVELOPMENT

發展項目的住宅物業的樓面平面圖

3/F Floor Plan 3樓平面圖

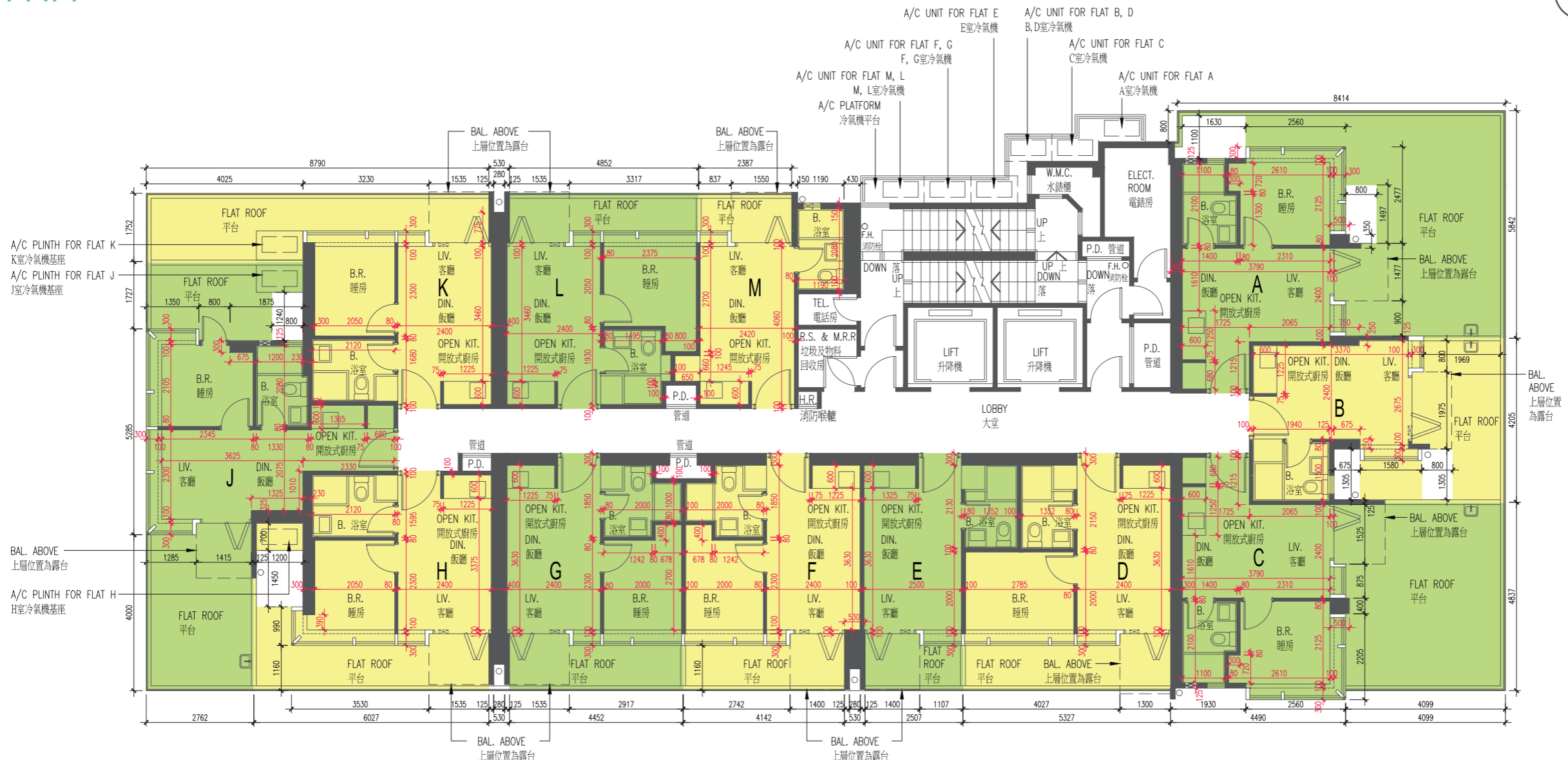

Each Residential Property 每個住宅物業	Flat 室	A	B	C	D	E	F	G	H	J	K	L	M
Floor-to-Floor Height (mm) 層與層之間的高度 (毫米)	3/F 3樓	3150	3150	3150	3150	3150	3150	3150	3150	3150	3150	3150	3150
Thickness of Floor Slab (excluding plaster) (mm) 樓板 (不包括灰泥) 的厚度 (毫米)	3/F 3樓	150	150	150	175	175	175	175	150	150	150	150	150

Notes:
 1. Blank areas on flat roof are common areas for building facility maintenance.
 2. The dimensions in floor plans are all structural dimensions in millimeter.

備註：
 1. 平台空白位置為供維修大廈設備使用的公用地方。
 2. 平面圖所列的數字為以毫米標示之建築結構尺寸。

The internal areas of the residential properties on the upper floors will generally be slightly larger than those on the lower floors because of the reducing thickness of the structural walls on the upper floors.
 因住宅物業的較高樓層的結構牆的厚度遞減，較高樓層的內部面積，一般比較低樓層的內部面積稍大。

Please refer to page 18 of this sales brochure for the remarks and legends of the terms and abbreviations for the floor plans of residential properties.
 請參閱本售樓說明書第18頁為住宅物業樓面平面圖而設之備註及名詞及簡稱的圖例。

10 FLOOR PLANS OF RESIDENTIAL PROPERTIES IN THE DEVELOPMENT

發展項目的住宅物業的樓面平面圖

5/F - 9/F Floor Plan 5樓至9樓平面圖



Each Residential Property 每個住宅物業	Flat 室 Floor 樓層	A	B	C	D	E	F	G	H	J	K	L	M
Floor-to-Floor Height (mm) 層與層之間的高度 (毫米)	5/F - 9/F 5樓至9樓	3150	3150	3150	3150	3150	3150	3150	3150	3150	3150	3150	3150
Thickness of Floor Slab (excluding plaster) (mm) 樓板 (不包括灰泥) 的厚度 (毫米)		150	150	150	175	175	175	175	150	150	150	150	150

Notes:
The dimensions in floor plans are all structural dimensions in millimeter.

備註：
平面圖所列的數字為以毫米標示之建築結構尺寸。

The internal areas of the residential properties on the upper floors will generally be slightly larger than those on the lower floors because of the reducing thickness of the structural walls on the upper floors.
因住宅物業的較高樓層的結構牆的厚度遞減，較高樓層的內部面積，一般比較低樓層的內部面積稍大。

Please refer to page 18 of this sales brochure for the remarks and legends of the terms and abbreviations for the floor plans of residential properties.
請參閱本售樓說明書第18頁為住宅物業樓面平面圖而設之備註及名詞及簡稱的圖例。

10 FLOOR PLANS OF RESIDENTIAL PROPERTIES IN THE DEVELOPMENT

發展項目的住宅物業的樓面平面圖

10/F - 12/F, 15/F - 22/F Floor Plan

10樓至12樓, 15樓至22樓平面圖



0M/米
Scale: 比例 5M/米

Each Residential Property 每個住宅物業	Flat 室	A	B	C	D	E	F	G	H	J	K	L	M
Floor-to-Floor Height (mm) 層與層之間的高度 (毫米)	10/F - 12/F, 15/F - 22/F 10樓至12樓, 15樓至22樓	3150	3150	3150	3150	3150	3150	3150	3150	3150	3150	3150	3150
Thickness of Floor Slab (excluding plaster) (mm) 樓板 (不包括灰泥) 的厚度 (毫米)		150	150	150	175	175	175	175	150	150	150	150	150

Notes:
The dimensions in floor plans are all structural dimensions in millimeter.

備註:
平面圖所列的數字為以毫米標示之建築結構尺寸。

The internal areas of the residential properties on the upper floors will generally be slightly larger than those on the lower floors because of the reducing thickness of the structural walls on the upper floors.
因住宅物業的較高樓層的結構牆的厚度遞減, 較高樓層的內部面積, 一般比較低樓層的內部面積稍大。

Please refer to page 18 of this sales brochure for the remarks and legends of the terms and abbreviations for the floor plans of residential properties.
請參閱本售樓說明書第18頁為住宅物業樓面平面圖而設之備註及名詞及簡稱的圖例。

10 FLOOR PLANS OF RESIDENTIAL PROPERTIES IN THE DEVELOPMENT

發展項目的住宅物業的樓面平面圖

23/F, 25/F -31/F Floor Plan 23樓, 25樓至31樓平面圖



0M/米 5M/米
Scale: 比例

Each Residential Property 每個住宅物業	Flat 室 Floor 樓層	A	B	C	D	E	F	G	H	J	K	L	M
Floor-to-Floor Height (mm) 層與層之間的高度 (毫米)	23/F, 25/F -31/F 23樓, 25樓至 31樓	3150	3150	3150	3150	3150	3150	3150	3150	3150	3150	3150	3150
Thickness of Floor Slab (excluding plaster) (mm) 樓板 (不包括灰泥) 的厚度 (毫米)		150	150	150	175	175	175	175	150	150	150	150	150

Notes:
The dimensions in floor plans are all structural dimensions in millimeter.

備註:
平面圖所列的數字為以毫米標示之建築結構尺寸。

The internal areas of the residential properties on the upper floors will generally be slightly larger than those on the lower floors because of the reducing thickness of the structural walls on the upper floors.
因住宅物業的較高樓層的結構牆的厚度遞減, 較高樓層的內部面積, 一般比較低樓層的內部面積稍大。

Please refer to page 18 of this sales brochure for the remarks and legends of the terms and abbreviations for the floor plans of residential properties.
請參閱本售樓說明書第18頁為住宅物業樓面平面圖而設之備註及名詞及簡稱的圖例。

10 FLOOR PLANS OF RESIDENTIAL PROPERTIES IN THE DEVELOPMENT

發展項目的住宅物業的樓面平面圖

Roof Floor Plan 天台平面圖

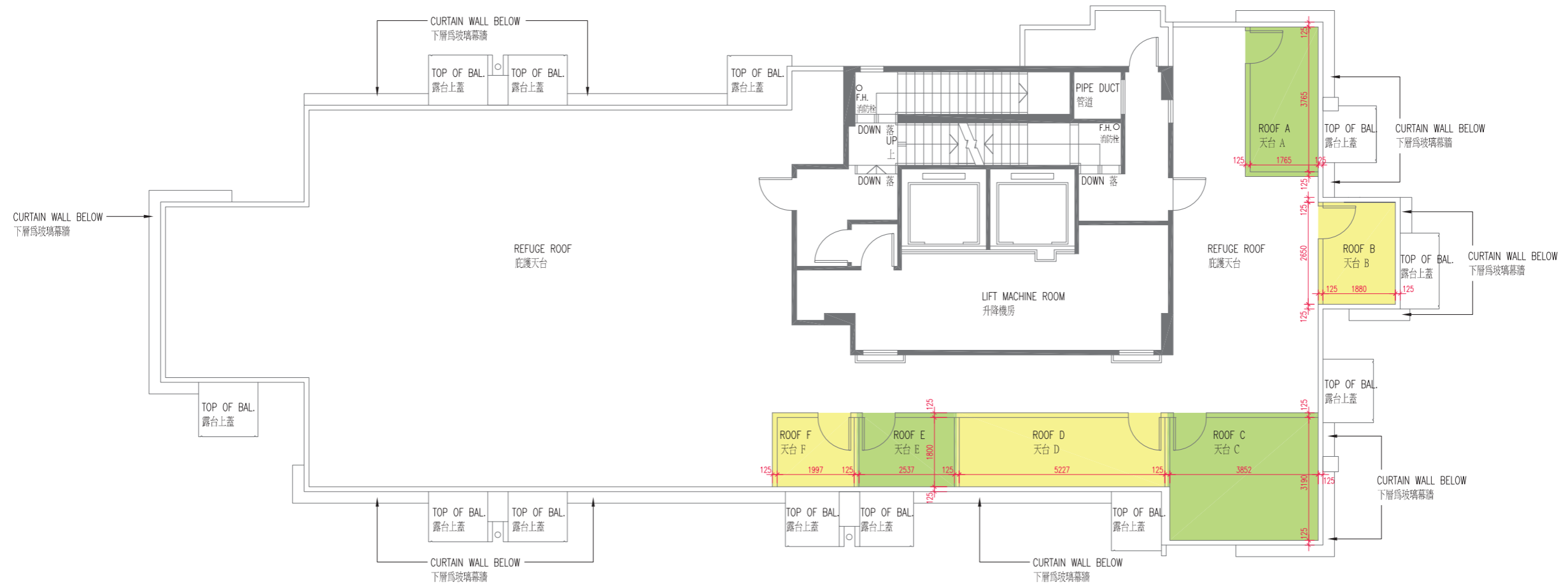

0M/米
Scale: 比例
5M/米

Each Residential Property 每個住宅物業	Floor 樓層	Flat 室	A	B	C	D	E	F
Floor-to-Floor Height (mm) 層與層之間的高度 (毫米)	Roof 天台		Not Applicable 不適用					
Thickness of Floor Slab (excluding plaster) (mm) 樓板 (不包括灰泥) 的厚度 (毫米)			Not Applicable 不適用					

Notes:
The dimensions in floor plans are all structural dimensions in millimeter.

備註：
平面圖所列的數字為以毫米標示之建築結構尺寸。

The internal areas of the residential properties on the upper floors will generally be slightly larger than those on the lower floors because of the reducing thickness of the structural walls on the upper floors.
因住宅物業的較高樓層的結構牆的厚度遞減，較高樓層的內部面積，一般比較低樓層的內部面積稍大。

Please refer to page 18 of this sales brochure for the remarks and legends of the terms and abbreviations for the floor plans of residential properties.
請參閱本售樓說明書第18頁為住宅物業樓面平面圖而設之備註及名詞及簡稱的圖例。